

TRIVAC D 40 B and D 65 B

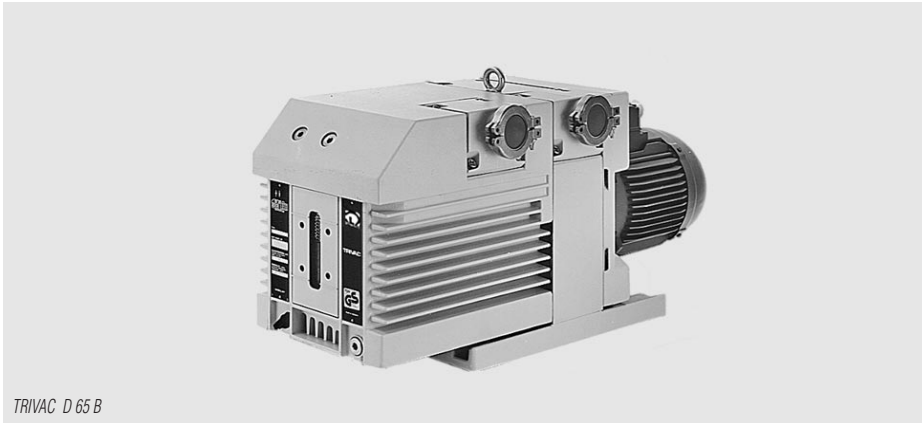

TRIVAC D 65 B

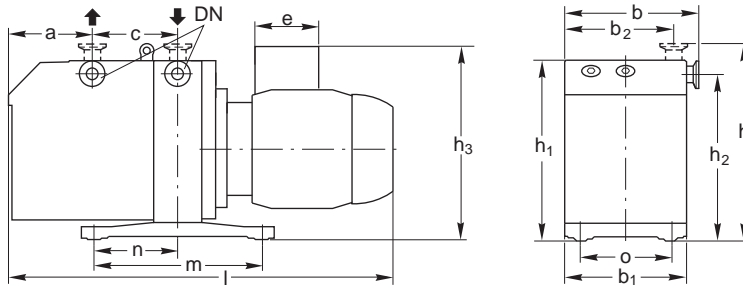

* Depending on the motor

USA pumps max. length
 D 40 B 760 mm (30")
 D 65 B 840 mm (33.1")

Type	DN	a	b	b ₁	b ₂	c	e	h	h ₁	h ₂	h ₃	l	m	n	o	
D 40 B (Part No. 112 86)	40 KF	mm	135	264	234	206	166	111	355	336	308	302	676	382	191	190
		in.	5.32	10.39	9.21	8.11	6.54	4.37	13.98	13.23	12.13	11.89	26.61	15.04	7.52	7.48
D 40 B (Part No. 113 45)	40 KF	mm	135	264	234	206	166	u. r.	u. r.	u. r.	u. r.	u. r.	u. r.	382	191	190
		in.	5.32	10.39	9.21	8.11	6.54	u. r.	u. r.	u. r.	u. r.	u. r.	u. r.	15.04	7.52	7.48
D 40 B (Part No. 113 47)	40 KF	mm	135	264	234	206	166	111	355	336	308	302	667	382	191	190
		in.	5.32	10.39	9.21	8.11	6.54	4.37	13.98	13.23	12.13	11.89	26.26	15.04	7.52	7.48
D 65 B (Part No. 112 96, 113 57)	40 KF	mm	213	264	234	206	166	111	355	336	308	302	750	382	191	190
		in.	8.39	10.39	9.21	8.11	6.54	4.37	13.98	13.23	12.13	11.89	29.53	15.04	7.52	7.48
D 65 B (Part No. 113 55)	40 KF	mm	213	264	234	206	166	u. r.	u. r.	u. r.	u. r.	u. r.	u. r.	382	191	190
		in.	8.39	10.39	9.21	8.11	6.54	u. r.	u. r.	u. r.	u. r.	u. r.	u. r.	15.04	7.52	7.48

Dimensional drawing for the TRIVAC D 40 and D 65 B

u. r. = upon request

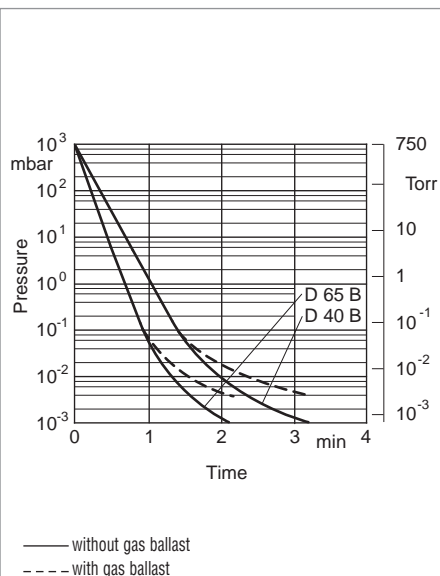

Pump-down characteristics of a 100 l vessel at 50 Hz

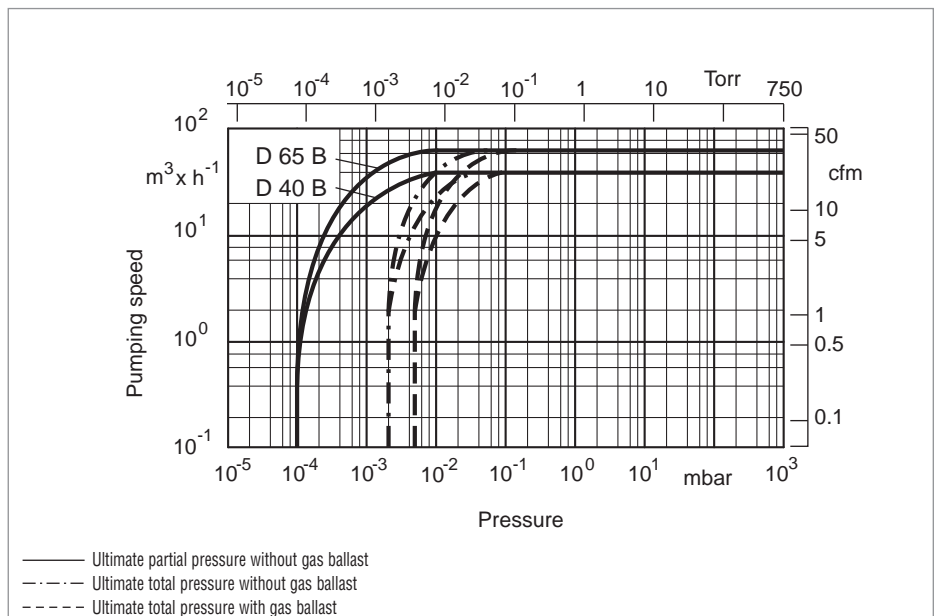

Pumping speed characteristics at 50 Hz (60 Hz curves at the end of the section)

Technical Data		TRIVAC D 40 B		TRIVAC D 65 B	
		50 Hz	60 Hz	50 Hz	60 Hz
Nominal pumping speed ¹⁾	m ³ x h ⁻¹ (cfm)	46 (27)	55 (32.5)	75 (44)	90 (53)
Pumping speed ¹⁾	m ³ x h ⁻¹ (cfm)	40 (24)	48 (28)	65 (38)	78 (46)
Ultimate partial pressure without gas ballast ¹⁾	mbar (Torr)	10 ⁻⁴ (0.75 x 10 ⁻⁴)			
Ultimate total pressure without gas ballast ¹⁾	mbar (Torr)	< 2 x 10 ⁻³ (< 1.5 x 10 ⁻³)			
Ultimate total pressure with gas ballast ¹⁾	mbar (Torr)	< 5 x 10 ⁻³ (< 3.8 x 10 ⁻³)			
Water vapor tolerance ¹⁾	mbar (Torr)	40 (30)			
Water vapor capacity	gm/h	1184		1925	
Oil filling, min./max.	l (qt)	1.7 / 2.6 (1.8 / 2.7)		2.0 / 3.3 (2.1 / 3.5)	
Noise level ²⁾ to DIN 45 635, without/with gas ballast	dB(A)	57/59			
Admissible ambient temperature	°C (°F)	12 - 40 (54 - 104)			
Motor rating ²⁾	W (HP)	2200 (3)			
Nominal speed	rpm	1500	1800	1500	1800
Type of protection ³⁾	IP	54			
Weight ²⁾	kg (lbs)	68 (150)		80 (177)	
Connections, Intake and Exhaust	DN	40 KF			

Version for the North and South American Continents

Ordering Information	TRIVAC D 40 B two-stage	TRIVAC D 65 B two-stage
TRIVAC B, with 3-phase motor 208-230/460 V, 60 Hz / 200-220/380 V, 50 Hz	Part No. 912 86-2	Part No. 912 96-2

Global Version

Ordering Information	TRIVAC D 40 B two-stage	TRIVAC D 65 B two-stage
TRIVAC B, with 3-phase motor 230/400 V, 50 Hz / 250/440 V, 60 Hz 230/400 V, 50 Hz, Exe II T3 200/346 V, 50 Hz / 208/360 V, 60 Hz	Part No. 112 86 Part No. 113 45 Part No. 113 47	Part No. 112 96 Part No. 113 55 Part No. 113 57

Accessories		
Roots pump adaptor		Part No. 168 30
FS 30-60 dust filter		Part No. 186 15
AS 30-60 dust separator		Part No. 186 16
MF 30-60 molecular filter		Part No. 186 17
FA 30-60 fine vacuum adsorption trap		Part No. 187 15
Adsorption trap with aluminium oxide Activated aluminium oxide, 1.3 kg (2 l approx.)		Part No. 854 16 Part No. 854 10
AF 40-65 exhaust filter		Part No. 189 16
AR 40-65 exhaust filter with lubricant return		Part No. 189 22
AK 40-65 condensate trap		Part No. 188 16
OF 40-65 mechanical oil filter		Part No. 101 92
CF 40-65 chemical oil filter		Part No. 101 97
Connector for gas ballast inlet M 16 x 1.5 – DN 16 KF		Part No. 168 40
Oil drain tap		Part No. 190 90
Spare parts		
Inside section	Part No. E 200 10 933	Part No. E 200 10 944
Seal kit		Part No. 197 22

¹⁾ To DIN 28 400 and following numbers

²⁾ Weight, motor rating and noise levels for the pumps with 3-phase motor, 50 Hz, only.

Any data that deviate from the above for pumps with other motors, and other motor-dependent data are given in section "Products", paragraph "Motor Dependent Data for the TRIVAC B, BCS and BCS-PFPE"

³⁾ Global versions only. North and South American versions are TEFC