

# VACUUM BOOSTERS



## HV Series

400 –1600 CFM

- Compact direct drive design
- May be used with VFD drive
- Higher vacuum capability
- Increases system pumping capacity
- Inter-changeable with industry standard

## HV-K Series “ROOTS” Type Vacuum Boosters

U.S. Vacuum HV Series Mechanical Vacuum Boosters are heavy duty roots type blowers made to be used in conjunction with a mechanical vacuum pump to “supercharge” the vacuum system.

Using a pressure switch to energize the booster after system pressure has been reduced, these unit will add volume and ultimate vacuum capability of your existing vacuum pump. The boosters has internal mechanical seals to isolate the pumping chamber process gases from the timing gear oil reservoir reducing oil contamination and premature failure.

FFKM (Kalrez) mechanical seals. Nickel-phosphate coating of boosters pumping chamber & rotors for corrosion protection.

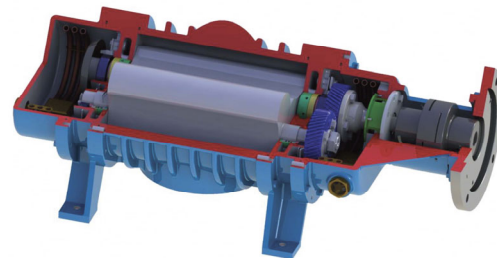

### TECHNICAL SPECIFICATIONS

Model	HV400K	HV540K	HV720K	HV850K	HV1600K
Displacement (CFM)	400	541	718	853	1600
Motor (HP)	3	5	5	7.5	10
Max Speed (RPM)	3600	3600	3600	3600	3600
Inlet/Discharge	4" ANSI	4" ANSI	4" ANSI	6" ANSI	6" ANSI
Backing Pump size (CFM)	50-200	50-250	75-350	100-400	150-800
Noise (DbA)	82	82	82	82	82
Cooling water flow (gpm)	0.5				
Cooling water connection	1/4" NPT				
Oil Capacity (Qt)	1	1.5	1.5	4	4
Weight (Lbs)	194	260	300	450	580

# VACUUM BOOSTER DIMENSIONS

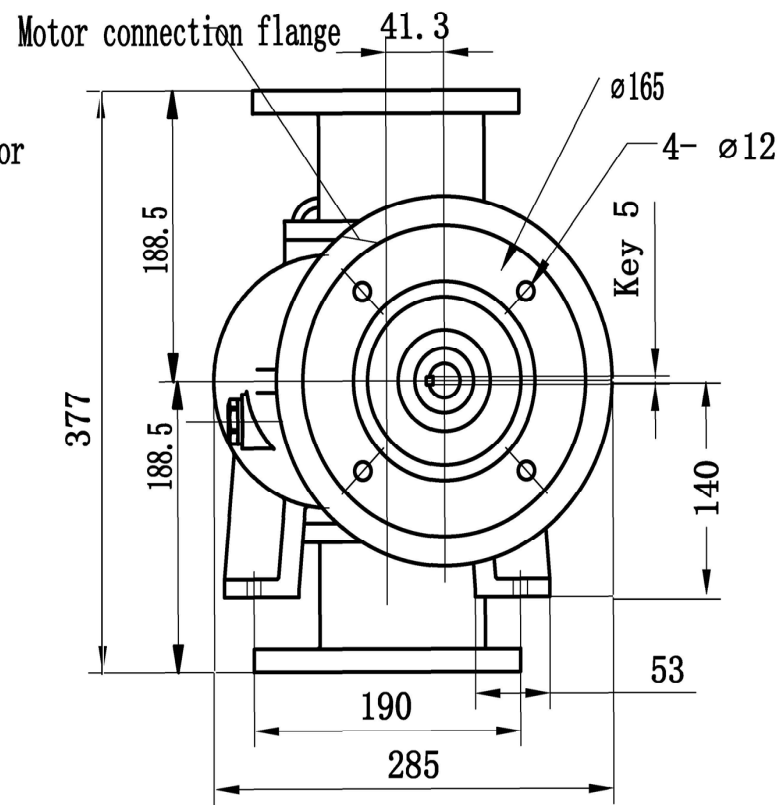
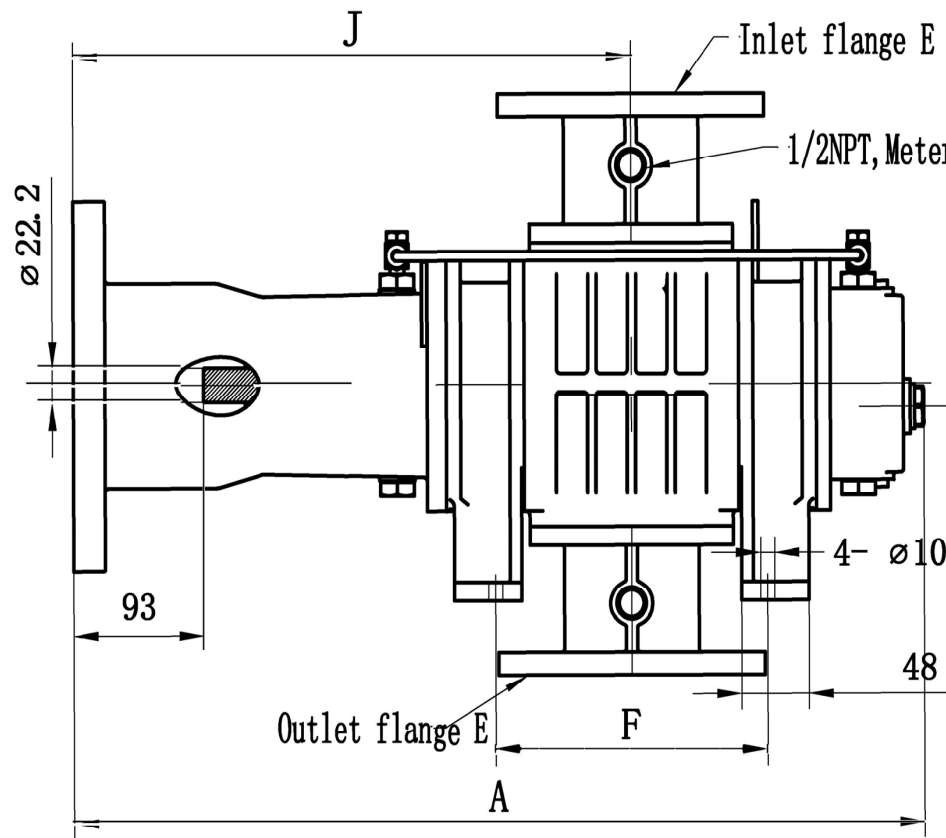

HV 200 inlet and outlet flange size

HV 400 inlet and outlet flange size

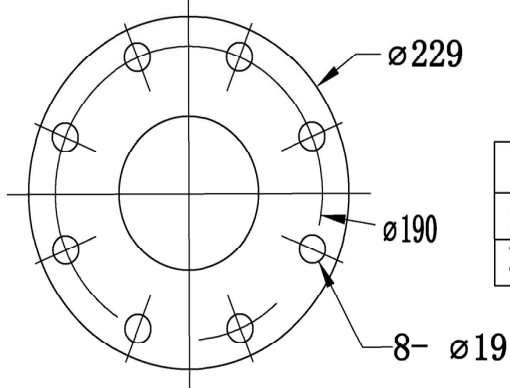
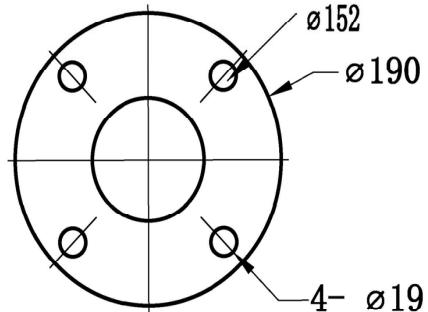

Model	A	E	F	J
HV 200	607	ANSI 80	194	398
HV 400	706	ANSI 100	295	449



US VACUUM PUMPS LLC CANTON, TEXAS

VACUUM PUMP DIMENSIONAL DRAWING

HV series

# VACUUM BOOSTER DIMENSIONS

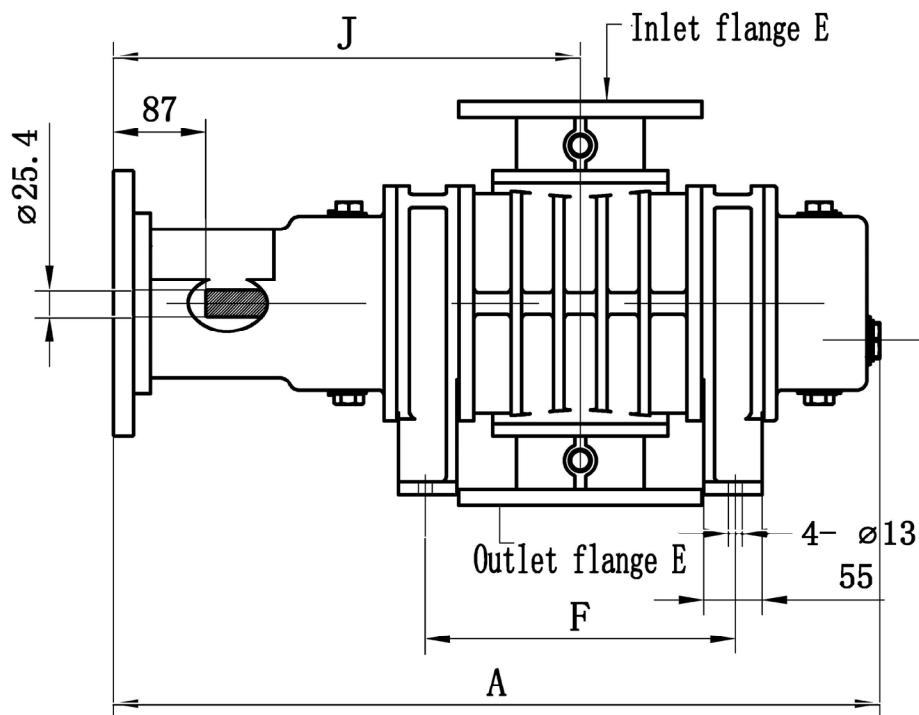

Motor connection flange

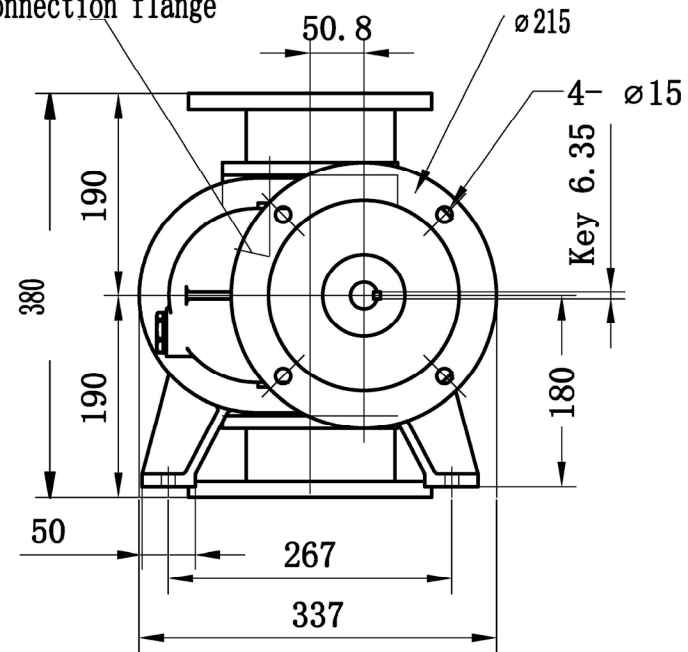

Inlet and outlet flange size

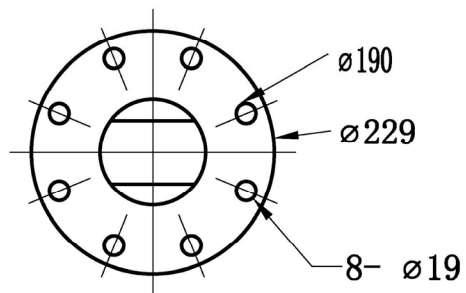

Model	A	E	F	J
HV540K	718	ANSI 100	292	440
HV720K	794	ANSI 100	368	478



VACUUM BOOSTER DIMENSIONAL DRAWING

HV series

# VACUUM BOOSTER DIMENSIONS

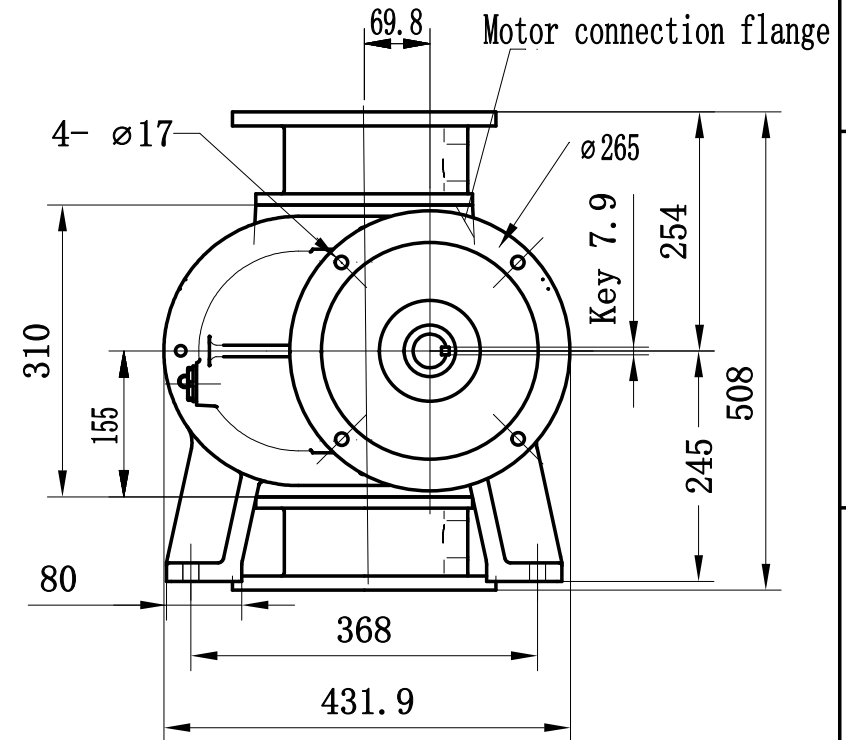
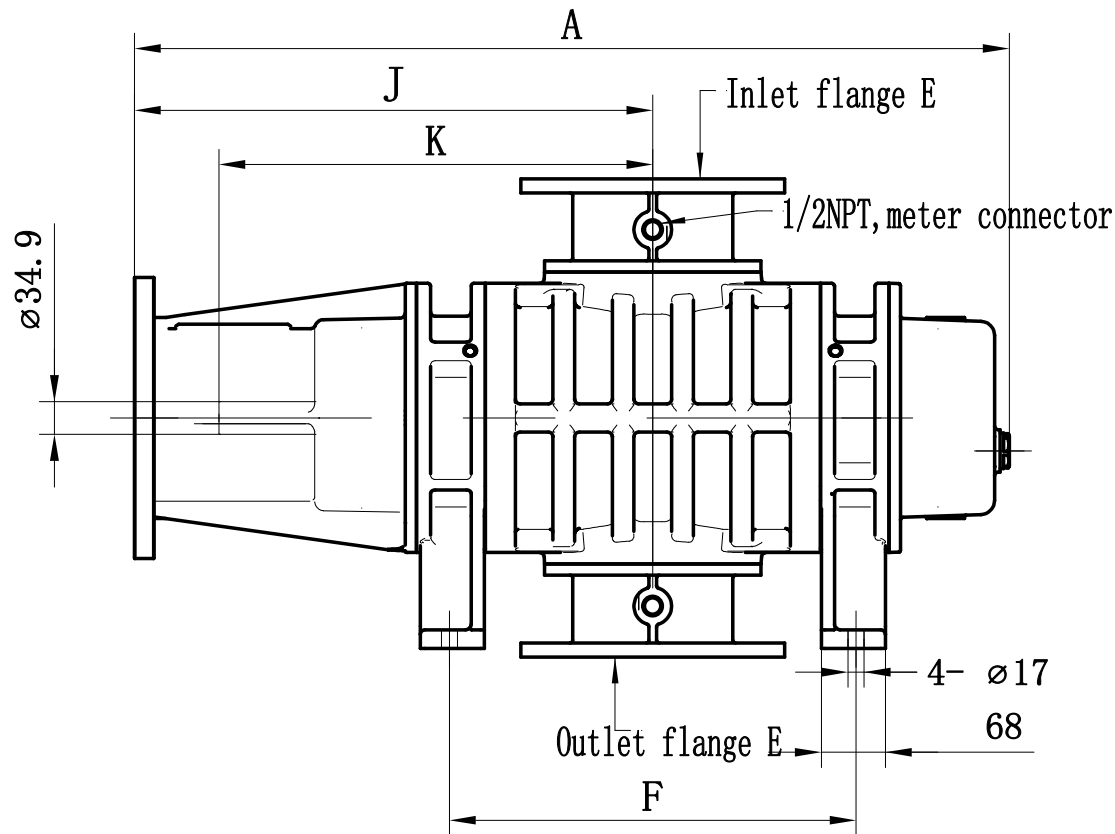

Inlet and outlet flange size

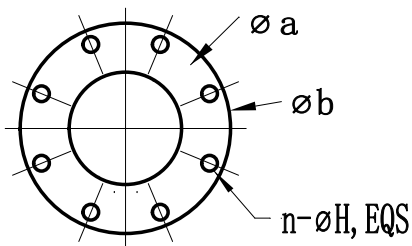

Model	A	E	F	J	K	n	H	$\phi a$	$\phi b$
HV 850K	765	ANSI 150	267	467	378	8	22	241.3	280
HV 1200K	854	ANSI 150	356	513	423	8	22	241.3	280
HV 1600K	930	ANSI 150	432	551	461	8	22	241.3	280
HV 2000K	1031	ANSI 200	533	602	511	8	22	298.5	345
HV 2700K	1183	ANSI 250	686	678	588	12	26	362	405



US VACUUM PUMPS LLC CANTON, TEXAS

Vacuum pump dimension drawing

HV series